

*MAJESTY*  *YACHTS*



## SUPERYACHT COLLECTION





135

*MAJESTY 135*















Main Saloon









Upper Deck Saloon





Main Galley



Dining Area

Step onto the exclusive Majesty 135, a masterpiece of engineering and elegance. Featuring three decks of absolute bliss, this 42m superyacht is a floating palace that offers infinite comfort and flawless design like you have never seen before. This “luxury villa on the water” features only the highest quality fixtures and fittings throughout, including chandeliers, silver-leaf ceilings, premium marbled en-suites and large dining tables.



Owner's Stateroom





Owner's En Suite

This spectacular superyacht has six staterooms for 14 overnight guests with ample room for both spending quality time with your guests and for taking longer private trips. The Majesty 135 also includes additional cabins to accommodate five crew members.





Double Guest Stateroom





Double Guest En Suite





Twin Guest Stateroom





Twin Guest En Suite





Wheelhouse





Crew Cabin



Crew Galley



Fly-bridge Jacuzzi

Operated by state-of-the-art technology, the Majesty 135 features advanced entertainment systems throughout and space for all of your holiday essentials. Every inch of this superyacht has been optimized, with a spa pool deck that offers top-of-the-range seating for sunbathing and sizeable interior lounging areas, which are filled with beautiful natural light from the ocean on a daily basis.





Beach Club











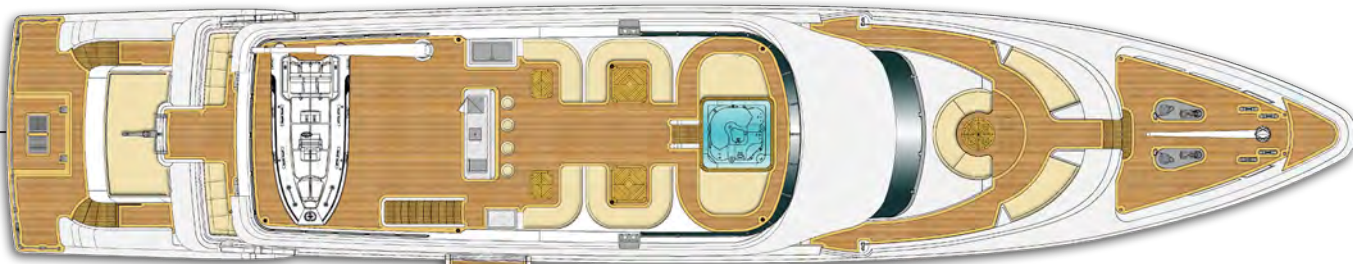

FLY-BRIDGE



UPPER DECK

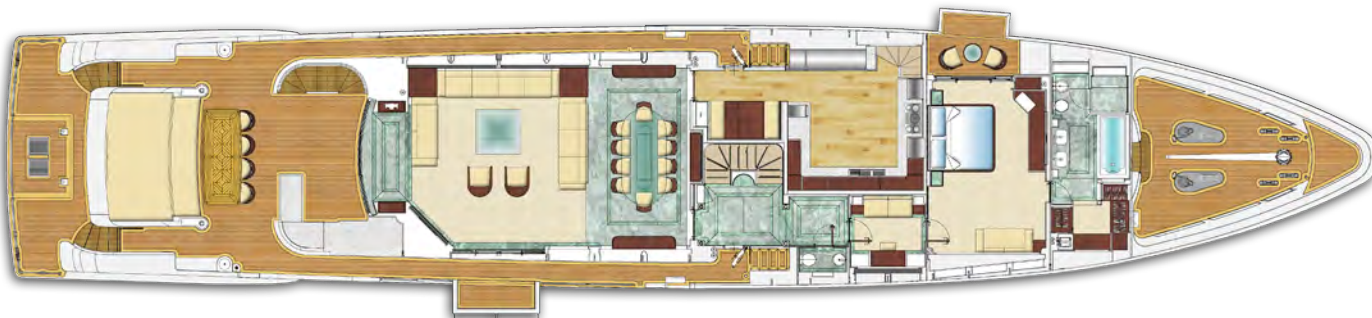

MAIN DECK



LOWER DECK

The layouts shown are some of the possible options and do not necessarily correspond to the standard version.



---

# TECHNICAL SPECIFICATIONS

LENGTH OVERALL	141 ft 7 in (43.16 m)
BEAM	26 ft 11 in (8.20 m)
DRAFT	6 ft 11 in (2.11 m)
DISPLACEMENT	225 t approximately
FUEL CAPACITY	10,970 US gal (41,525 l )
FRESH WATER CAPACITY	1,888 US gal (7,148 l )
BLACK WATER CAPACITY	380 US gal (1,1438 l )
GREY WATER CAPACITY	380 US gal ( 1,438 l )
GENERATORS	2 X 80 kW, 50 Hz
ENGINES	2 X 2,600 hp

Please note this is the technical specifications of Majesty 135. Gulf Craft reserves the right to add, modify or delete specifications and features at any time as part of our continuous product improvement programme.

Please note this is the technical specifications of Majesty 135. Gulf Craft reserves the right to add, modify or delete specifications and features at any time as part of our continuous product improvement programme.

DECK FITTINGS

- Teak wood fitted on swim platform, main deck aft cockpit, side decks, upper deck aft cockpit and sundeck.
- Port side pantograph door access to main deck Pantry.
- Starboard side pantograph door access to Main deck Lobby.
- Main deck aft cockpit port side pantograph door access to Crew cabin.
- Port and Starboard side bulwark doors at aft and mid ship.
- Ladder for side access.
- Hydraulic Anchor windlass with hand controls (2).
- Stainless steel bow guard and anchor pockets.
- 185kg Anchors (2).
- Chains for anchors – Length:123M; Diameter: 16mm (2 nos).
- Capstans located at aft cockpit (2).
- Stainless deck cleats on forward area (4).
- Hawser pipes (6)
- Deck hatch access to chain locker.
- Fresh water deck wash outlets at main deck forward, aft and upper deck and sun deck.
- Stainless steel hand railings.
- Safety glass side windows and front wind screen.
- Front wind screen wipers with fresh water washing system.
- Self draining.
- Lighting around the side decks.
- Upholstered sofa seats at forward area.
- Storage within the forward sofa seat moulding.
- Fixed round teak table with stainless steel base.
- Stainless steel guard railing at main deck, upper deck and sundeck.
- Fuel fillers, water fillers and black tank overboard discharge on side deck.
- Name board with LED lighting.
- Stainless steel flagpoles on upper deck aft.
- Round shape portholes.
- Crane 500kg capacity (at main deck forward area).
- Crane 1000kg capacity (at sundeck).

MAIN DECK AFT COCKPIT

- Stainless steel framed sliding door to Saloon.
- Cockpit lighting.
- Stainless steel hand railings.
- Fixed teak table with stainless steel bases.
- Upholstered sofa seats.
- Speakers linked with Saloon entertainment system (2).
- Storage within aft seat moulding.
- Integral stairway with teak steps and stainless steel handrails to upper deck aft cockpit.
- Stainless steel Transom doors.
- Staircase to crew cabin.
- Steps to down bathing platform.
- Hydraulic Transformer.
- Stainless steel Stanchions.
- Stainless steel deck cleats at aft cockpit (2).
- Hot and cold water hand shower.
- Locker with Fire damper pull-pin cables, Emergency fuel shutoff valve pull-pin cable, Engine room fire cylinder pull-pin cable.

- Locker with fire hydrant valve and fire hose reel with nozzle.
- 3-Phase, 125Amps dock side connection with 30 meter length cable and cable master system (2).
- Fresh water input and outlet.
- Self draining.
- Pop-up cleats on bathing platform (2).

UPPER DECK AFT COCKPIT

- Stainless steel framed sliding door to Conference dining cabin.
- Dining table.
- Dining chairs (10).
- Corian counter top.
- Port and Starboard side upholstered sofa seats.
- Storage within the sofa seat moulding.
- Teak decking.
- Stairway from main deck aft cockpit with teak steps and stainless steel handrails.
- Stair way to Sun deck with teak steps and stainless steel handrails.
- Stainless steel guard railings.
- Self draining.
- Life rafts capacity 8 persons (4)

FLY-BRIDGE

- Bar counter.
- Bar stools with backrest (5).
- Port and Starboard side upholstered exterior sofa seats and tables.
- Storage within the sofa seat moulding.
- Stainless steel framed wind deflector screen.
- Fiberglass hard top.
- Electric Barbeque.
- Jacuzzi.
- Ice box.
- Storage lockers.
- Lighting on underside of hard top.
- Stainless steel hand railings around the aft area of fly-bridge.
- Deck lights and flood lights.
- Tap with hot and cold water supply.
- Fridge.
- Ice maker.

MAST

- Platform for radar and aerials.
- Lighting arrestor.
- Anchor light.
- Mast head light.
- GPS Antenna.
- VHF Antenna.
- Not Under Command light 1.
- Not Under Command light 2.
- Pan tilt camera.
- AFT Search light.
- Radars.
- TV satellite.

UPPER DECK PORT DOCKING STATION

- Engine control switches.
- Steering joystick.
- Bow thruster joystick.
- Rudder angle gauge.
- Engine throttle.
- Horn switch.

UPPER DECK STARBOARD DOCKING STATION

- Engine remote controls.
- Steering joystick.
- Rudder angle gauge.
- Horn switch.

SALOON

- LED TV 65”.
- Home Theater system (Life style 48 Series).
- Satellite Receiver.
- Stainless steel framed sliding entrance door.
- Sofa seats on port and starboard side.
- Sofa side tables.
- Fitted carpet.
- Side windows with Roman and Pleated blinds.
- Architectural and cabinet lighting.
- Lighting switches and AC sockets.
- Air conditioning with control switch.
- Port and Starboard side wall cabinets with shelves.
- Telephone point.
- Curtains for main saloon door.
- Port and Starboard side entrance doors to day head, pantry and main lobby.

DAY HEAD TOILETS (PORT & STARBOARD SIDE)

- Vanity locker with Marble counter top.
- Wash basin and Tap with hot and cold water supply.
- Mirror.
- Bidet & Electric toilet.
- Extractor fan.
- Architectural, vanity and cabinet lighting.
- Lighting switches and AC sockets.
- Marble flooring.
- Marble wall panels.
- Sanitary accessories.

PANTRY

- Lockable water tight door leading to port side deck.
- Stainless steel sink.
- Wash basin and tap with hot and cold water supply.
- Tap with hot and cold water supply.
- Marble counter top.
- Refrigerator.
- Hob.
- Hood.
- Oven.
- Microwave oven.
- Dish washer.
- Shelf.
- Overhear lockers.
- Air conditioning with control switches.
- Architectural lighting.
- Lighting switches and AC sockets.
- Telephone point.
- Windows with pleated blinds.
- Vinyl flooring.
- Entrance door to lower deck forward guest corridor.

MAIN LOBBY

- Entrance doors from main saloon.
- Stairs to lower deck guest lobby.
- Stairs to upper deck lobby.
- Elevator.
- Watertight side door leading to Starboard side deck.
- Sliding door to owner’s office.
- Marble flooring.
- Storage locker.
- Architectural lighting.
- Lighting switches and AC sockets.
- Veneer/Fabric/Leather wall panels.

OWNER’S OFFICE

- Desk with chair.
- Sofa seat.
- Storage locker with shelf.
- Fitted carpet.
- Window with Roman blinds and Pleated blinds.
- Architectural lighting.
- Cabinet lighting.
- Reading lights.
- Lighting switches and AC sockets.
- Air conditioning with control switch.
- Fabric/Leather wall panels.
- Entrance door to day head toilet (stbd).
- Entrance door to owner’s suite.

OWNER’S STATEROOM

- LED TV 65”.
- Home Theater system (Life style 48 Series).
- Satellite Receiver.
- Large double bed with drawers (4) & mattress, pillows and bedspread.
- Bed side tables.
- Port and Starboard side low cabinets.
- Port and Starboard side wardrobes.
- Windows with Roman blinds and Pleated blinds.
- Fitted carpet.
- Air conditioning with control switch.
- Reading, architectural and cabinet lighting.
- Lighting switches and AC sockets.
- Telephone points.
- Entrance door to bath cabin.
- Sliding door to walk-in closet.
- Fabric/Leather wall panels.

EN SUITE

- Vanity locker.
- Wash basin and tap with hot and cold water supply.
- Desk and stool.
- Shelf.
- Mirror.
- Glass door to shower cabin.
- Bidet and Electric toilet.
- Sanitary accessories.
- Extractor Fan.
- Architectural, vanity and cabinet lighting.
- Shower lighting.
- Lighting switches and AC sockets.
- Side window with wooden blinds.

WALK-IN CLOSET

- Wardrobes.
- Shelves.
- Drawers.
- Side windows with roman blinds and pleated blinds.
- Fitted carpet.
- Veneer/Leather/Fabric wall panels.
- Lighting switches and AC sockets.

GUEST LOBBY

- Stairs from main deck.
- Storage.
- Elevator.
- Entrance door to port side mid twin guest cabin.
- Entrance door to starboard side mid twin guest cabin.
- Entrance door to port side double guest cabin.
- Entrance door to starboard side double guest cabin.
- Marble flooring.
- Architectural lighting.
- Veneer wall panels.

AFT DOUBLE GUEST STATEROOMS (PORT SIDE & STARBOARD SIDE)

- LED TV 40”.
- Satellite Receiver.
- Large double bed with drawers & mattress, pillows and bed spreads.
- Twin bed side tables.
- Wardrobe.
- Desk and stool.
- Fitted carpet.
- Air conditioning with control switch.
- Reading, architectural and cabinet lighting.
- Lighting switches and AC sockets.
- Entrance door to En Suite.
- Fabric/Leather wall panels.
- Windows with Roman and Pleated blinds.
- Telephone point.

EN SUITE

- Vanity locker.
- Wash basin and tap with hot and cold water supply.
- Storage locker.
- Mirror.
- Bidet and Electric toilet.
- Sanitary accessories.
- Glass door to shower cabin.
- Seat in shower cabin.
- Hot and cold water shower mixer.
- Sky shower.
- Port hole with wooden blinds.
- Marble flooring.
- Marble wall panels.
- Architectural, vanity and cabinet lighting.
- Shower lighting.
- Lighting switches and AC sockets.
- Port hole with wooden blinds.

MID TWIN GUEST STATEROOMS (PORT SIDE & STARBOARD SIDE)

- LED TV 26”.
- Satellite Receiver.
- 2 x Single beds with drawers &mattresses, pillows and bed spreads.
- Bed side table.
- Wardrobe.
- Storage locker.
- Fitted carpet.
- Air conditioning with control switch.
- Entrance door to En Suite.
- Side window with Roman and Pleated blinds.
- Telephone point.
- Fabric/Leather wall panels.
- Reading, architectural and cabinet lighting.
- Lighting switches and AC sockets.

EN SUITE

- Vanity locker.
- Wash basin and tap with hot and cold water supply.
- Mirror.
- Bidet & electric toilet.
- Sanitary accessories.
- Frosted glass door for shower cabin.
- Hot and cold water shower mixer.
- Sky shower.
- Seat in shower cabin.
- Marble flooring.
- Marble wall panels.
- Port hole with wooden blinds.
- Architectural and cabinet lighting.
- Shower light.
- Lighting switches and AC sockets.

UPPER DECK LOBBY

- From Panoramic saloon to dayhead, wheelhouse and stairs down to main deck.
- Vanity locker with marble counter top.
- Wash basins and tap with hot and

- cold water supply (3).
- Marble flooring.
- Architectural lighting.
- LED lighting to steps.
- Lighting switches and AC sockets.
- Stairwell wall panels.
- Elevator.
- Entrance door to wheelhouse.
- Entrance door to day head toilet.
- Sliding door to panoramic saloon.

WHEELHOUSE

- Air conditioning with control switch.
- Architectural, chart and night lighting.
- Lighting switches and AC sockets.
- Sofa seat.
- Storage lockers.
- Fabric wall panels.
- Wooden flooring.
- Water tight side pantograph doors on port and starboard side.

MAIN HELM

- Helm seat with fore and aft adjustment system.
- Port and starboard side engine displays.
- Bow thruster control.
- General alarm.
- Detection fire alarms.
- AFT search light controls.
- FWD search light controls and switches.
- MCU 001 Keyboard controls (2).
- Port and Starboard side engine room exhaust fan controls (2).
- Trim tab gauge and switch.
- Compass.
- Steering wheel.
- Horn switch.
- Engine Throttle.
- Auto pilot.
- Wiper controls.
- Night vision controls.
- Whistle control.
- Anchor winch controls (2).
- Satellite compass.
- Bow thruster pump switch.
- Stabilizer display.
- Navigation displays.
- Port and Starboard side engine parameter gauges.
- Rudder angle indicator.
- Navigation lights panel.
- Multi displays (2).
- MSB display.
- VHF Radio hand set.
- Tanks display.
- AIS (Automatic Identification System).
- Radar display.
- Radar display backup.
- Navitex receiver.
- MF/HF receiver.
- Bilge pumps switches.

CAPTAIN’S CABIN

- LED TV 26”.
- Satellite Receiver.
- Large double bed with drawer & mattress, pillows and bed spreads.
- Storage under the bed.
- Desk and stool.
- Storage lockers and wardrobe.
- Book shelf.
- Wardrobe.
- Windows with Roman blinds and Pleated blinds.
- Air conditioning with control switch.
- Reading, architectural and cabinet lighting.
- Lighting switches and AC sockets.
- Entrance door to En Suite.
- Fitted carpet.
- Telephone point.



CAPTAIN'S BATHROOM

- Vanity locker with marble counter top.
- Wash basin and tap with hot and cold water supply.
- Electric toilet.
- Extractor fan.
- Hot and cold water shower mixer.
- Sky shower.
- Mirror.
- Sanitary accessories.
- Architectural, vanity and cabinet lighting.
- Shower light.
- Lighting switches and AC sockets.
- Marble flooring.

MAIN GALLEY AND CREW LOUNGE

- LED TV 20".
- Satellite Receiver.
- Counter top.
- Stainless steel sink and tap with hot and cold water supply.
- Fridge.
- Washing machine/Dryer.
- Microwave oven.
- Hob.
- Deep fryer.
- Grill.
- Storage lockers.
- Over head lockers.
- Air conditioning with control switch.
- Porthole with pleated blinds.
- Vinyl flooring.
- Stools.
- Sofa and table.
- Architectural lighting.
- Lighting switches and AC sockets.
- Telephone point.
- Entrance door to crew cabin 01.
- Entrance door to crew cabin 02.
- Lockable water tight door leading to swim platform.
- Lockable water tight entrance door to engine room.
- Stairs to upper deck aft cockpit.
- Stainless steel hand railings.
- Dumbwaiter.

CREW CABINS (1 & 2)

- 2 x Single bed with mattress, pillows and bed spreads.
- Wardrobe.
- Air conditioning with control switch.
- Fabric wall panels.
- Vinyl flooring.
- Entrance door to En Suite.
- Port hole with Pleated blinds.
- Reading, architectural and cabinet lighting.
- Lighting switches and AC sockets.

EN SUITE

- Vanity counter with corian top.
- Sink and tap with hot and cold water supply.
- Electric toilet.
- Mirror.
- Hot and cold water shower mixer.
- Sky shower.
- Sanitary accessories.
- Architectural lighting.
- Lighting switches and AC sockets.

FORWARD CREW CABINS (3 & 4)

- 2 x Single bunk beds with mattress, pillows and bed spreads.
- Wardrobe.
- Air conditioning with control switch.
- Vinyl flooring.
- Port holes with Pleated blinds.
- Fabric wall panels.
- Entrance door to En Suite.

- Reading and architectural lighting.
- Lighting switches and AC sockets.

EN SUITE

- Vanity with corian counter top.
- Sink and tap with hot and cold water supply.
- Shelf.
- Mirror.
- Electric toilet.
- Hot and cold water shower mixer.
- Sky shower.
- Sanitary accessories.
- Architectural lighting.
- Lighting switches and AC sockets.

CONFERENCE DINING CABIN

- LED TV 55".
- Satellite Receiver.
- Bar counter.
- Sink and Tap with hot and cold water supply.
- Bar stools (4).
- Storage cabinets.
- Round dining tables (4).
- Dining chairs.
- Fridge.
- Bottle cooler.
- Fitted carpet.
- Telephone point.
- Air conditioning with control switch.
- Architectural and cabinet lighting.
- Cabinet lighting.
- Lighting switches and AC sockets.
- Fabric/Leather wall panels.
- Windows with Roman and Pleated blinds.
- Patio door with curtains to upper deck aft cockpit.
- Sliding door to upper deck lobby.

ELECTRICAL SYSTEM

- Electrical system of the boat is 3-phase, 380415V, 50Hz (limiting fluctuations in shore power voltage to +/- 4%).
- Main shore power supplied by two generators (80Kw, Kohler).
- 380415V, 50Hz, 3-phase, 125Amp dockside connection (125Amp) with cable master system at aft cockpit port and starboard side.
- Telephone and television dockside connection.
- Power management and load sharing protection system.
- Motorized isolation battery switches.
- 12V, 200Amp Batteries for Port side engine (2).
- 12V, 200Amp Batteries for Starboard side engine (2).
- 12V, 100Amp Batteries for Port and Starboard side Generators (2).
- 12V, 200Amp Batteries for Service (2).
- 12V, 200Amp Batteries for Machinery (2).
- 12V, 200Amp Batteries for Emergency bank (2).
- Batteries are charged by five battery chargers.
  - 24V, 100Amp Battery charger for Service and Machinery batteries.
  - 24V, 100Amp Battery charger Port and Starboard engine batteries.
  - 24V, 80Amp Battery charger for Emergency batteries.
  - 24V, 30Amp Battery charger for Generator batteries.
  - 24V, 50Amp Battery charger for MF/HF Radio.
- Main switch board system equipped with magnetic contactors, overload protections and short circuit protections.
- 380415V panel is equipped with the following apparatus for each generator.

- Volt meter with select switch.
- Frequency indicator.
- Ampere meter with current transformers.
- Watt meter.
- Signal light on.
- Signal light alarm.
- Signal light disconnect.
- For shore connections:
  - Volt meter with select switch.
  - Ampere meter with current transformers.
  - Phase sequence meter.
  - Signal light connect.
  - Signal light disconnect.
  - Signal light shore energized.
- For 24V system:
  - Voltmeter for general service battery.
  - Voltmeter with change over switch for the engine starting batteries.
  - Ampere meter.
- Outgoing circuits protected by circuit breakers.
- All motors to be 220V, single phase and 380415V, 3-phase, 50 Hz.
- All cables to be color coded.
- Protection to the phase line sequence.
- Main panel in wheelhouse contain following:
  - Navigation lights.
  - Deck lighting.
  - Navigation equipments.
- 220V AC power outlets in all cabins.
- Navigation lights according to the international regulations.
  - Navigation lights (red and green).
  - Stern light.
  - Head on mast.
  - Anchor light on mast.
  - NUC Light -1.
  - NUC Light -2.
- Tank senders for all tanks.
- Emergency lighting for all cabins.
- Extractor fans (3- phase) for engine room venting system (2).

POWER AND DRIVE SYSTEM

- Direct shaft drive through tunnels.
- Propellers, 5-bladed, AB2 material (2).
- Bronze P-brackets (2).
- Bronze rudders (2).
- Duplex steel tail shafts (2).
- Hydraulic bow thruster 100 HP.
- TRAC 540 Stabilizing system.
- Seawater strainers for main engines/generators.
- Hydraulic trim tabs (2).
- Cathodic protection provided by zinc anodes and copper plates.

FUEL SYSTEM

- Total fuel capacity 8522 US Gallons (32255 Liters).
- All tanks provided with manholes, fill pipes, ventilation pipes, and connection pipes to manifold.
- Manual fuel shutoff valve.
- Racor fuel filters for generators.
- Electric fuel transfers pump 380V/3-phase.
- Fuel levels are visible on monitoring panel.
- Manual fuel transfer pump.
- Isolation valves to fuel manifold.
- Fuel fillers on Port and Starboard side deck.
- Fuel lines are made of stainless steel.
- Fuel pipe connections to engines/ generators by flexible hoses/ stainless steel pipes.

FRESH WATER SYSTEM

- Fresh water capacity 2840 U.S. Gallons (10749 Liters).
- AC fresh water pump 230V (2), 50Hz, 5Amps pressure system.
- Pressurized hot and cold water system.
- Marine standard electric water heaters capacity 67Lts (3).
- Water heated by 240V immersion heater.
- GF piping throughout supplying all outlets.
- Filling and ventilations to side deck.
- Dock connection for shore water supply on aft swimming platform with pressure reducer.
- Handheld shower on swim platform with hot and cold water supply.
- Water makers 1800Gallons/day, 380415V, 3 phase, 50 Hz for fresh water (2).
- Inline filters for fresh water system.

FIRE EXTINGUISHING SYSTEM

- Electric pumps with bypass valves for firefighting purpose.
- Fresh water line connected to manifold for priming and cleaning system.
- Fire alarm connected with all cabins smoke sensors.
- Portable dry powder fire extinguishers in all cabins.
- FM 200 fire extinguishing system for engine room.
- Engine room fire extinguisher emergency handle fitted at aft cockpit port recessed locker.
- Fuel shutoff valve emergency handle fitted at aft cockpit port side recessed locker.
- Engine room extractor fan emergency switches located at aft cockpit port side recessed locker.
- Fire plumbing lines are made of CuNiFer/Stainless steel pipes.

BILGE SYSTEM

- High water level alarm system for each water tight compartment.
- Automatic bilge pumps fitted in each water tight compartment (3700GPH).
- Fire and bilge line manifold system is installed in engine room.
- Mechanical pump with bypass valves for fire and bilge purpose.
- Hand operated diaphragm pump with bypass valves for suction of the bilges in each water tight compartment.
- Bilge suction lines are connected to mechanical pump.
- Bilge lines are made of CuNiFer/ Stainless steel pipes.

AIR CONDITIONING SYSTEM

- Chilled water air conditioning system with capacity 600 000 BTU.
- All compressors on 380415V and handlers on 220V.
- Sea water pumps for chillers (2).
- Chiller water pumps (2).
- Chillers, Chiller water pumps, Sea water pumps placed in engine room.
- All plumbing lines are made from PVC pipes.
- All plumbing lines are well insulated.
- Chillers sea water cooling pipe lines are made of CuNiFer/ stainless steel.
- A/C control switches in all cabins.

COMMUNICATION SYSTEM

- Phontech system - (Intercom and telephone system provided with five lines and 18 channels), all cabins, pilot house, fly-bridge and engine room.
- SART (Search And Rescue Transponder).
- EPIRB.
- Loud hailer.
- Provision for Antenna and Telephone (connection at shore power box).

NAVIGATION SYSTEM

- 19" Multi display monitors in the Main helm (2).
- FURUNO Navigation system.
  - GPS (2).
  - Radars - 12Kw, 4Kw (2).
  - Depth sounder (2).
  - Speed logs and wind speed.
  - Auto pilot.
  - VHF Radio.(Navigation system upgrade is available on request as optional)
- Mast area—equipped with radars, satellite antenna, horn , wind speed, navigation lights, Lightening arrester, search light (Jabsco) fwd and aft, horn (T3 model).
- Camera (PAN/TILT/ZOOM) at Flybridge, Main deck Aft cockpit and 2 at Engine room.
- Alarm Monitoring System for All tanks, A/C Chiller pumps, Black water pump, Steering pump, Smoke detectors, Bilge Alarm, Navigation Lights, STP Alarm indication, Water maker, Fresh water pumps, Doors Windows and Hatches.

LIFE RAFT AND SAFETY EQUIPMENTS

- Solas Life jackets (24).
- 24" Life rings (2).
- Life rafts capacity of 8 persons each (4)
- First Aid kit (2)
- Fire blanket (2)
- Fire dampers safety on Port and Starboard side vent shaft.
- Portable fire extinguishers as per plan.



P.O. Box 666, Sheikh Khalifa Bin Zayed Street, Ajman, United Arab Emirates

T. +971 6 7406060, F. +971 6 7406062, [gci@gulfcraftinc.com](mailto:gci@gulfcraftinc.com)

**[www.gulfcraftinc.com](http://www.gulfcraftinc.com)**

**[www.majesty-yachts.com](http://www.majesty-yachts.com)**

V 03. 2017

---

Pictures in this catalogue may be taken from different vessels of the same type for example purpose only. Performance estimates are given in good faith, but are in no way guaranteed. Dirt on the hull, damage to the propellers, external water and air temperatures and added weight, fuel and water carried can all adversely affect performance. For these and other reasons we can give no performance guarantees. Data and characteristics are not binding: details, colors, descriptions and illustrations are for information purpose only. The drawings and pictures may include specific equipment or modifications which are not part of the standard specifications of the vessel. Standard specifications may be defined differently in different sales territories. Gulf Craft Inc. reserves the right to make any changes in specifications or equipment without prior notice. In case on any inconsistencies between specification sheet, product catalogue and price list, the price list prevails. Customers are recommended to contact one of our sales representatives to reconfirm standard and optional features on the vessels.





SETTING NEW STANDARDS OF LUXURY

by *Gulf Craft*

V 0.3 2017